

機械加工尺寸一般容許公差					REV.	DATE	DESCRIPTION	CHANGER	CHECK
尺寸	長寬高	尺寸	孔徑	軸徑					
1 < 10	±0.2	1 < 10	+0.2 -0.2	+0.2 -0.2					
10.001 < 100	±0.3	10.001 < 100	+0.3 -0.3	+0.3 -0.3					
100.001 < 250	±0.5	100.001 < 250	+0.5 -0.5	+0.5 -0.5					
250.001 < 500	±0.8	250.001 < 500	+1.0 -1.0	+1.0 -1.0					
500 <	±1.3	500 <	+1.5 -1.5	+1.5 -1.5					

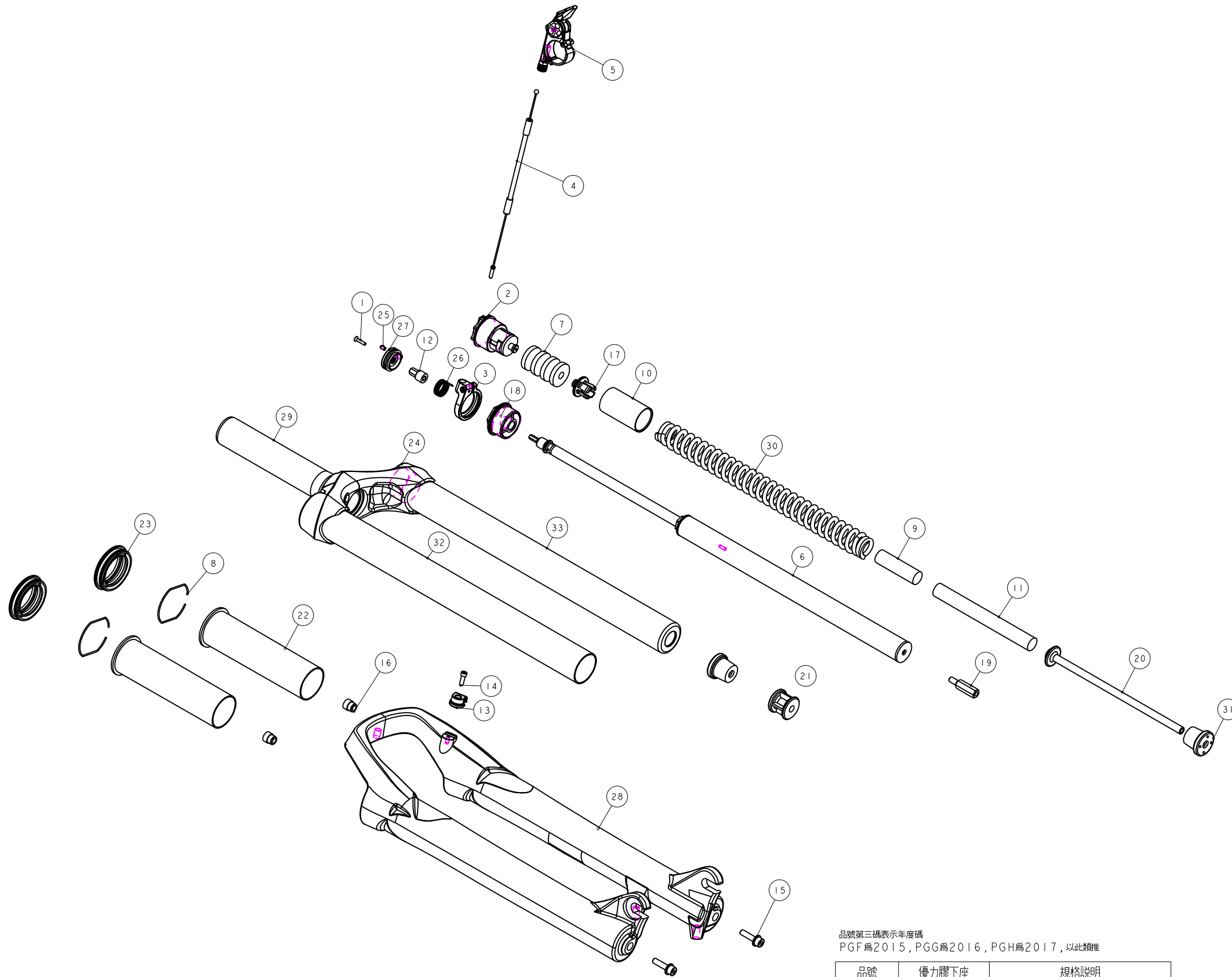

33	M5GSTAE1345B100	PART	內管	Slanchion	1	Φ32x345L-#
32	M5GSTAE0345B100	PART	內管	Slanchion	1	Φ32x345L-#
31	M5GSPB-420-8	PART	緩衝墊	Top-Out Bumper	2	
30	M5GSP91260-110	PART	彈簧	Spring	1	
29	M5GRTBA260	ASSEMBLY	轉向管	Sleerer	1	
28	M5GFRED5-1000	PART	OMEGA27.5外管		1	總長2小
27	M5GDPAK03	PART	總控旋轉鈕	Turn Base	1	8h
26	M5GDP7ARL-020	PART	鉤簧	Corkscrew Coil Spring	1	20h
25	M5GDP7ARL-013	PART	止付螺絲	Grab screw	1	M3X5L
24	M5GCR1-FDGA2100	PART	OMEGA27.5頭管徑	Crown	1	
23	M5GBHBAEC1	ASSEMBLY	油封	OIL SEAL	2	TBD
22	M5GBHOAEB-1	PART	長型膠襯套	Bushing(plastic)	2	125L
21	M5GAEMB20	PART	外管座	Bottom-Out spacer	1	20L
20	M5GAEJC165	PART	優力膠下座	Compression Rod	1	165L
19	M5GAE9L023	PART	螺絲桿	Shank	1	M5X0.8
18	M5GAEOA29	PART	RA固定座	DT anchorage	1	M29*1.0
17	M5GAE-OPB020	PART	彈簧上座	Spring Guide	1	
16	M5GACF1031-01	PART	轉接座	ADAPTER	2	
15	M5GACC0617-02	PART	圓頭內六角螺絲	bolll	2	M5X20L
14	M5GAC9-1004	PART	圓頭內六角螺絲	HEX Bolts	1	M3X0.5X10L
13	M5GAC8-0731	PART	鎖式固定夾	Wire Clip	1	For M3x0.5
12	M5GACB-0404	PART	導套	Switch Stand	1	14.8L
11	M5FWS-2311-000	PART	定距橡皮	top out spring bumper	1	Φ13.8X120L
10	M5FUA-2310-000	PART	彈簧護套	Spring Sheath	1	NBR
9	M5FM2-2311-000	PART	定距橡皮	top out spring bumper	1	Φ13.8X48L
8	M5FHJ-2Y70-300	PART	C型扣環	CTW	2	TBD
7	M231-D24-L40-60	PART	壓縮橡皮	Compressible buna	1	Φ25.40L*HS50
6	H5GDPFBK14	ASSEMBLY	5'TNL鎖死棒(雙線牙版)	Travel lock-out Cartridge	1	行程120
5	H5GDPDAR3	ASSEMBLY	TRL撥桿組(鋅合金)	Tiny Remote Lockout	1	
4	H5GDPCARL3-1	ASSEMBLY	12'RL煞車總外線組	Remote Outline Assembly	1	
3	H5GDP8ARL6	ASSEMBLY	08'RL扣環組(高級)	Remote Outline Base	1	
2	H5GAE0A29	ASSEMBLY	10'調整座組 Φ32	Adjuster Assembly	1	M29X1.0
1	1022A-02512C-B	PART	六角承窩螺絲(黑)	HEX BOLT	1	M2.5x0.45

品號第三碼表示年度碼  
PGF為2015, PGG為2016, PGH為2017, 以此類推

品號	優力膠下座	規格說明
PGX022CG	M5GAEJC165	無軸 行程120mm 總高515mm
PGX022CF	M5GAEJC145	無軸 行程100mm 總高495mm
PGX022CE	M5GAEJC125	無軸行程80mm 總高475mm

Bill of material									
MATERIAL	ASSEMBLY	QTY	1	MODEL	OMEGA27.5 RL(80/100/120)				
UNIT	MM	SCALE	0.500	DRAW NO	PGX022CG	rev.	1.0		
FASHING	TREAT								
DESIGN	DRAWING	CHECK	CONFIG	APPE	NAME 爆炸圖				
RST									