

REV.	DATE	DESCRIPTION	CHANGER	CHECK
△	18 FEB '14	H5GDPFBK12-H5GDPFBK12 H5GDPBR1-H5GDPBR3	許智盛	

品號第三碼表示年度碼  
PGF為2015, PGG為2016, PGH為2017, 以此類推

項目	成品品號	外管替換料件品號	煞車軸	壓力膠下座	規格說明
1	PGX038CB	M5GFRYC1-0000	M5FKD-2723-000	M5GAEJC155	有軸、行程50mm、總高460mm
2	PGX038CC			M5GAEJC165	有軸、行程60mm、總高470mm
4	PGX039CB	M5GFRYC1-1000	不使用	M5GAEJC155	無軸、行程50mm、總高460mm
5	PGX039CC			M5GAEJC165	無軸、行程60mm、總高470mm

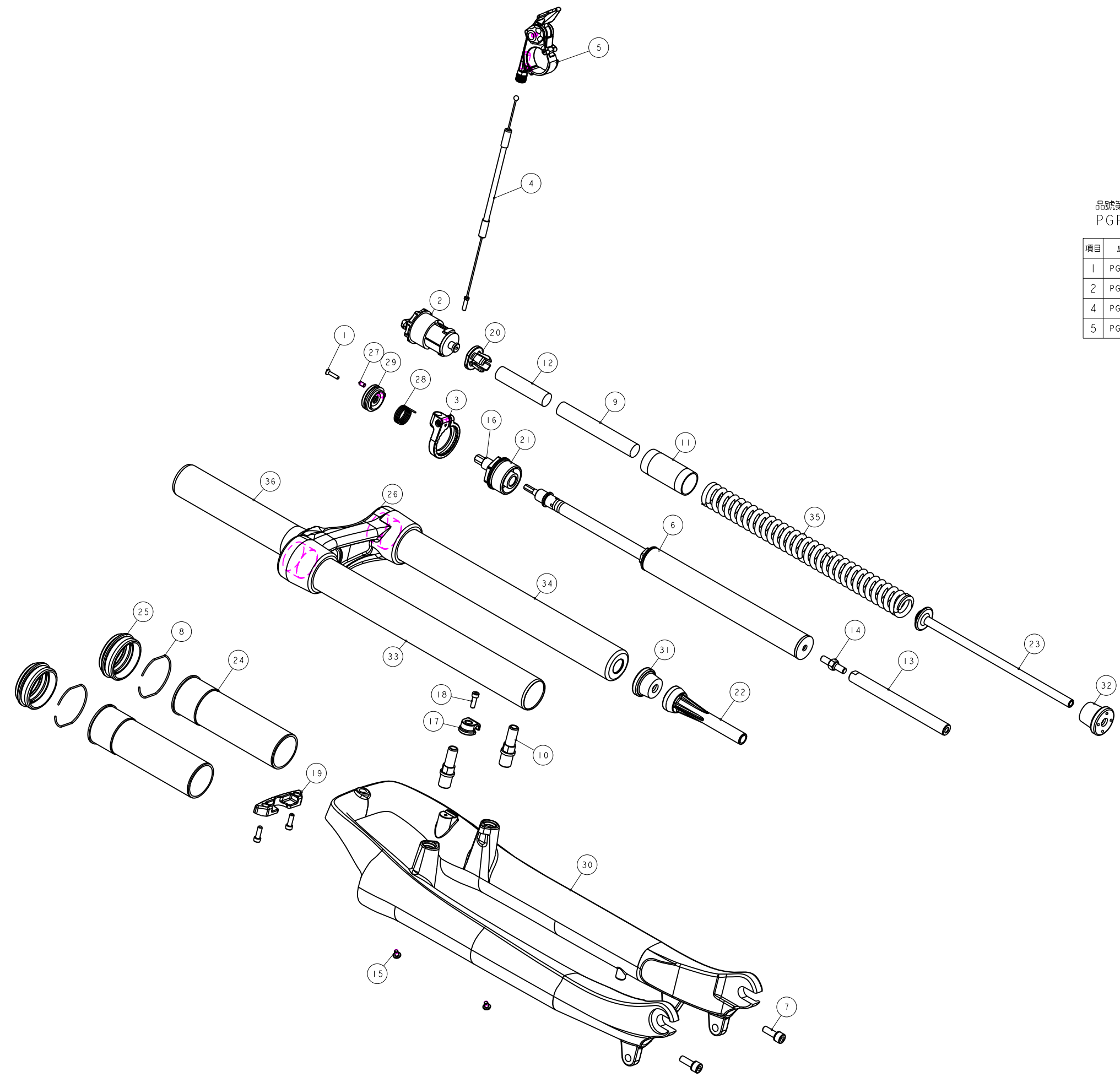

NO	PART NO	TYPE	CHINESE NAME	ENGLISH NAME	QTY	NOTE
36	MFPV-286-100	PART	轉內管	Steerer	1	±28.6
35	MF2350-220-145	PART	彈簧	Spring	1	220L
34	M5GSTAC1268A000	PART	內管		1	±28.6
33	M5GSTAC0268A000	PART	開口內管		1	±28.6
32	M5GSPB-420-8	PART	緩衝墊	Top-Out Bumper	1	
31	M5GSPB-415-8	PART	緩衝墊	Top-Out Bumper	1	15L
30	M5GFRYC1-0000	PART	12"NEON_PLS 外管成品		1	pitch112
29	M5GDPAK03	PART	總控旋轉組	Turn Base	1	8h
28	M5GDP7ARL-020	PART	彈簧	Corkscrew Coil Spring	1	20h
27	M5GDP7ARL-013	PART	止付螺絲	Grub screw	1	M3X5L
26	M5GCR7-DBG2000	PART	壓球帽(通孔28.6)	Crown	1	Pitch 112
25	M5GBHCC2	ASSEMBLY	油封	oil seal	2	∅37.6
24	M5GBH9ACB1	PART	NEON-PRO塑膠套	Bush	2	110L
23	M5GAEJC165	PART	壓力膠下座	Compression Rod	1	165L
22	M5GAEJC080	PART	外管套	bottom.out.space	1	±7.2±10±80L
21	M5GAEODA265	PART	DT固定座(DA, TNL共用)	DT anchorage	1	M26.5±1.0
20	M5GAE-0PB021	PART	彈簧套	Spring Guide	1	
19	M5GACC1220-01	PART	彈簧蓋		1	
18	M5GAC9-1004	PART	六角螺絲	HEX Bolts	3	M3X0.5X10L
17	M5GAC8-0731	PART	鎖式固定夾	Wire Clip	1	For M3x0.5
16	M5GAC8-0404	PART	導套	Switch Stand	1	14.8L
15	M5GAC01108	PART	導線螺絲	bolt	2	M3X0.5
14	M5FUE-2Y14-005	PART	螺絲桿	Shank	1	2-M5X0.8
13	M5FUE-2Y10-105	PART	內螺絲接管	pitman	1	M5X0.8-105L
12	M5FQ9-2310-000	PART	定距橡皮	Top-Out Bumper	1	±12X52L Hs40M
11	M5FNL-2311-000	PART	彈簧護套	Spring Sheath	1	TBD
10	M5FKD-2723-000	PART	煞車軸	pivot	2	M10X1.25
9	M5FKA-2311-000	PART	定距橡皮	Top-Out Bumper	1	±12X82L Hs40M
8	M5FHJ-2Y70-000	PART	C型環	RETAINING RING	2	TBD
7	M5FA2-2Y12-100	PART	六角螺絲	HEX Bolts	2	M5x0.8x15L
6	H5GDPFBK12	ASSEMBLY	15"TNL 鎖死棒(雙線牙)	Travel lock-out Cartridge	1	±W120
5	H5GDPDR3	ASSEMBLY	TRL 鎖桿組(銅合金)	Tiny Remote Lockout	1	
4	H5GDPCARL3-1	ASSEMBLY	12"RL 煞車線外線組	Remote Outline Assembly	1	
3	H5GDPBARL6	ASSEMBLY	08"RL 扣環組(高線)	Remote Outline Base	1	
2	H5FNM-2163-100	ASSEMBLY	調整螺絲 2006	Adjuster Assembly	1	M26.5X1.0
1	1022A-02512C-B	PART	六角螺絲(黑)	HEX BOLT	1	M2.5x0.45

Bill of material						
MATERIAL	Assembly	QTY	1	MODEL	NOVA RL(50/60)	
UNIT	MM	SCALE	0.600	DRAW NO	PGX038CC	rev. 1.1
FASHING	TREAT			NAME	爆炸圖	
DESIGN	DRAWING	CHECK	CONFIG	APPE	RST	