

機械加工尺寸一般容許公差					REV.	DATE	DESCRIPTION	CHANGER	CHECK
尺寸	長寬高	尺寸	孔徑	軸徑					
1 << 10	±0.2	1 << 10	+0.2 0	+0 -0.2					
10.001 << 100	±0.3	10.001 << 100	+0.3 0	+0 -0.3					
100.001 << 250	±0.5	100.001 << 250	+0.5 0	+0 -0.5					
250.001 << 500	±0.8	250.001 << 500	+1.0 0	+0 -1.0					
500 <	±1.3	500 <	+1.5 0	+0 -1.5					

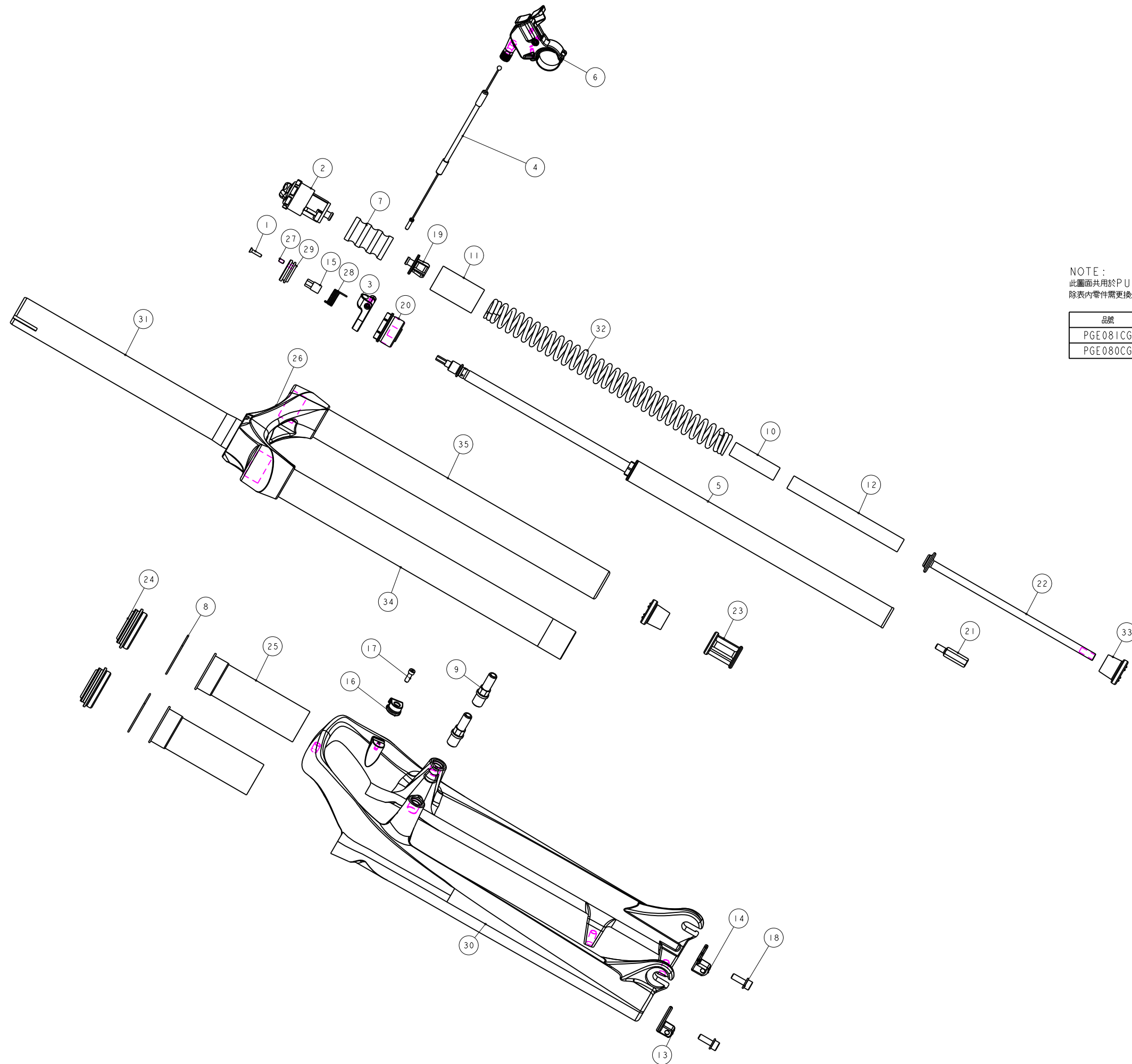

NOTE:
此圖面共用於PULSE29 RL(120)
除表內零件需更換外,其餘零件皆共用

品號	煞車軸	外管	規格說明
PGE081CG	M5FKD-2723-000	M5GFRJC2-0000	有軸 行程120mm 總高530
PGE080CG	不使用	M5GFRJC2-1000	無軸 行程120mm 總高530

35	M5GSTAD1345B000	PART	內管		1	•30X345L
34	M5GSTAD0345B000	PART	內管	Stanchion	1	•30X345L
33	M5GSPB-420-8	PART	緩衝墊	Top-Out Bumper	2	
32	M5GSP91260-110	PART	彈簧	Spring	1	
31	M5GRTG26000-1	PART	轉向管	STEERER	1	•28.6 260L
30	M5GFRJC2-0000	PART	2012 BLAZE29 外管		1	•30X345L
29	M5GDPAK03	PART	線控旋轉鈕	Turn Base	1	8h
28	M5GDP7ARL-020	PART	錯簧	Corkscrew Coil Spring	1	20h
27	M5GDP7ARL-013	PART	止付螺絲	Grub screw	1	M3X5L
26	M5GCRCIFCGA2000	PART	12"BLAZE29 管帽	Crown	1	
25	M5GBHEDB1-1	PART	長型膠圈	Bush	2	120
24	M5GBH8CDC2	ASSEMBLY	油封	oil seal	2	•30內徑
23	M5GAEMB30	PART	外管	Bottom-Out spacer	1	30L
22	M5GAEJC180	PART	壓力桿下座	Compression Rod	1	180L
21	M5GAE9L023	PART	螺絲桿	Shank	1	M5X0.8
20	M5GAE0DA275	PART	DT固定座(DA, TNL 共用)	DT anchorage	1	M27.5x1.0
19	M5GAE-0PB020	PART	彈簧上座	Spring Guide	1	
18	M5GACC0617-01	PART	圓筒內六角螺絲	bolt	2	M5X15L
17	M5GAC9-1004	PART	圓筒內六角螺絲	HEX Bolts	1	M3X0.5X10L
16	M5GAC8-0731	PART	鎖式固定夾	Wire Clip	1	For M3x0.5
15	M5GAC8-0404	PART	導套	Switch Stand	1	14.8L
14	M5GAC1203-106	PART			1	
13	M5GAC1203-105	PART			1	
12	M5FWS-2311-000	PART	定距橡皮	top out spring bumper	1	•13.8X120L
11	M5FUA-2310-000	PART	彈簧護套	Spring Sheath	1	NBR
10	M5FM2-2311-000	PART	定距橡皮	top out spring bumper	1	•13.8X48L
9	M5FKD-2723-000	PART	煞車軸	pivot	2	M10X1.25
8	M5FHJ-2Y70-100	PART	C型扣環	CIW	2	∅41.9x∅3x36
7	M231-D24-L40-60	PART	壓縮橡皮	Compressible buna	1	•25.40L-HS50
6	H5GDPCBR1	ASSEMBLY	2012年一般撥桿組	Remote control Assembly	1	
5	H5GDPCBK14	ASSEMBLY	TNL 鎖死棒(120)	Travel lock-out Cartridge	1	行程120
4	H5GDPCARL3-1	ASSEMBLY	12"RL 煞車線外線組	Remote Outline Assembly	1	
3	H5GDP8ARL6	ASSEMBLY	08"RL 扣環組(高級)	Remote Outline Base	1	
2	H5FVP-2162-100	ASSEMBLY	調整座組 2006	Adjuster Assembly	1	M27.5x1.0
1	1022A-02512C-B	PART	六角承蓋螺絲(黑)	HEX BOLT	1	M2.5x0.45
NO	PART NO	TYPE	CHINESE NAME	ENGLISH NAME	QTY	NOTE

Bill of material

MATERIAL	Assembly	QTY	1	MODEL	PULSE29 RL(120)	
UNIT	MM	SCALE	0.550	DRAW NO	PGE081CG	rev. 1.0
FASHING		TREAT		NAME	爆炸圖	
DESIGN	DRAWING	CHECK	CONFIG	APPE	RST	